

AENC-TQST-LAN-DWG-0002

# Norwich to Tilbury

## Volume 2: Plans, Drawings and Sections

Document: 2.2 Land Plans - Section G

Revision B

October 2025

Planning Inspectorate Reference: EN020027

Infrastructure Planning (Applications: Prescribed Forms and Procedure)  
Regulations 2009 Regulation 5(2)(i)(i)-(iii)

**nationalgrid**



LAND PLANS KEY PLAN  
REGULATION 5(2)(i)(i)-(iii)  
SECTION G (SHEET 1 OF 1)

CHELMSFORD CITY COUNCIL, BRENTWOOD BOROUGH COUNCIL, BASILDON BOROUGH COUNCIL AND THURROCK COUNCIL)

## SITE MAP

### Legend

- Local authority boundary
- Section boundary & local authority boundary
- ... Section boundary
- Sheet index
- Order Limits

## Notes

1. For additional detail on the plan suites, please refer to the Guide to Plans (document reference 2.0), located in the Volume 2 of the DCO application.
2. This drawing is scaled at paper size A0, therefore any prints taken at smaller sizes will affect accuracy of the measurement units and should not be scaled against.

Coordinate System: British National Grid  
Sheet X Centroid Coordinate : 585210      Sheet Y Centroid Coordinate : 194573



BACKGROUND MAPPING INFORMATION HAS BEEN REPRODUCED FROM THE ORDNANCE SURVEY BY PERMISSION OF ORDNANCE SURVEY OF THE CONTROLLER OF HIS MAJESTY'S STATIONERY OFFICE. © CROWN COPYRIGHT AND DATABASE RIGHTS (2025) LICENCE OS100024241 AND AC000807948.

B	OCT-2025	October 2025 Update	CLJ	AMI	TPR
A	AUG-2025	For DCO Submission	CLJ	KPA	TPR
<b>Issue</b>	<b>Date</b>	<b>Remarks</b>	<b>Drawn</b>	<b>Checked</b>	<b>Approved</b>

Title

THE NATIONAL GRID  
(NORWICH TO TILBURY) ORDER  
LAND PLANS KEY PLAN  
REGULATION 5(2)(i)(i)-(iii)  
SECTION G (SHEET 1 OF 1  
CHELMSFORD CITY COUNCIL,  
BRENTWOOD BOROUGH COUNCIL,  
BASILDON BOROUGH COUNCIL  
AND THURROCK COUNCIL)

**nationalgrid**

PINS Application Number

EN020027

### National Grid Drawing Reference

AENC-TQST-LAN-DWG-000

Scale

Sheet Size

Sheet

Sue



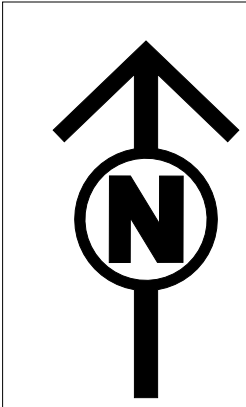

THE NATIONAL GRID (NORWICH TO TILBURY) ORDER  
LAND PLANS  
REGULATION 5(2)(i)-(iii)  
SECTION G (SHEET 1 OF 6,  
CHELMSFORD CITY COUNCIL AND BRENTWOOD BOROUGH COUNCIL)

Application Document 2.2

SITE MAP

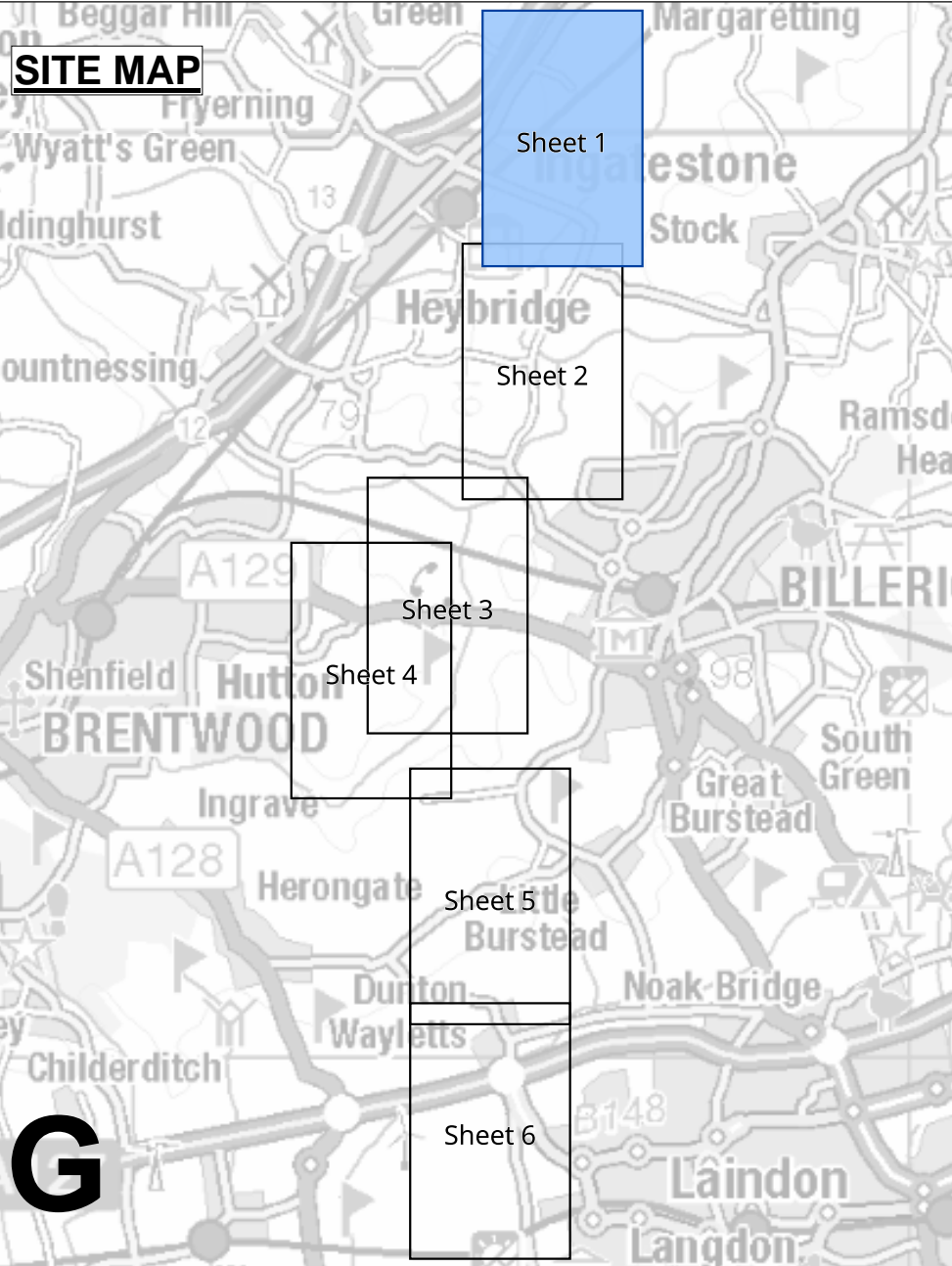

G

Legend

- Local authority boundary
- Section boundary & local authority boundary
- Section boundary
- Sheet index cutlines
- Order Limits
- Class 1 - Compulsory acquisition of land
- Class 2 - Compulsory acquisition of rights - Overhead line
- Class 3 - Compulsory acquisition of rights - Underground cable system
- Class 4 - Compulsory acquisition of rights - Overhead line and underground cable system
- Class 5 - Compulsory acquisition of rights - Access
- Class 6 - Compulsory acquisition of rights - Drainage
- Class 7 - Temporary use
- Class 8 - Land not subject to powers of acquisition nor temporary use

Notes

- For additional detail on the plan suites, please refer to the Guide to Plans (document reference 2.0), located in the Volume 2 of the DCO application.
- This drawing is scaled at paper size A0, therefore any prints taken at smaller sizes will affect accuracy of the measurement units and should not be scaled against.

Coordinate System: British National Grid  
Sheet X Centroid Coordinate : 566248 Sheet Y Centroid Coordinate : 199938

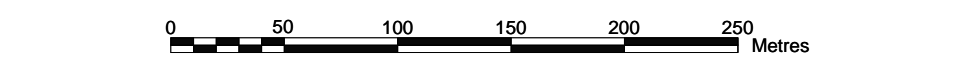

BACKGROUND MAPPING INFORMATION HAS BEEN REPRODUCED FROM THE ORDNANCE SURVEY BY PERMISSION OF ORDNANCE SURVEY OF THE CONTROLLER OF HIS MAJESTY'S STATIONERY OFFICE. © CROWN COPYRIGHT AND DATABASE RIGHTS (2025) LICENCE OS100024241 AND AC000807346.

Issue	Date	Remarks	Drawn	Checked	Approved
B	OCT-2025	October 2025 Update	CBE	AMI	CLJ
A	AUG-2025	For DCO submission	CBE	AMI	CLJ

Title:  
THE NATIONAL GRID  
(NORWICH TO TILBURY) ORDER  
LAND PLANS  
REGULATION 5(2)(i)-(iii)  
SECTION G (SHEET 1 OF 6,  
CHELMSFORD CITY COUNCIL  
AND BRENTWOOD BOROUGH COUNCIL)

**nationalgrid**

PINS Application Number  
EN020027

National Grid Drawing Reference  
AENC-TQST-LAN-DWG-0002

Scale	Sheet Size	Sheet	Issue
1:2,500	A0	SHEET 1 of 6	B

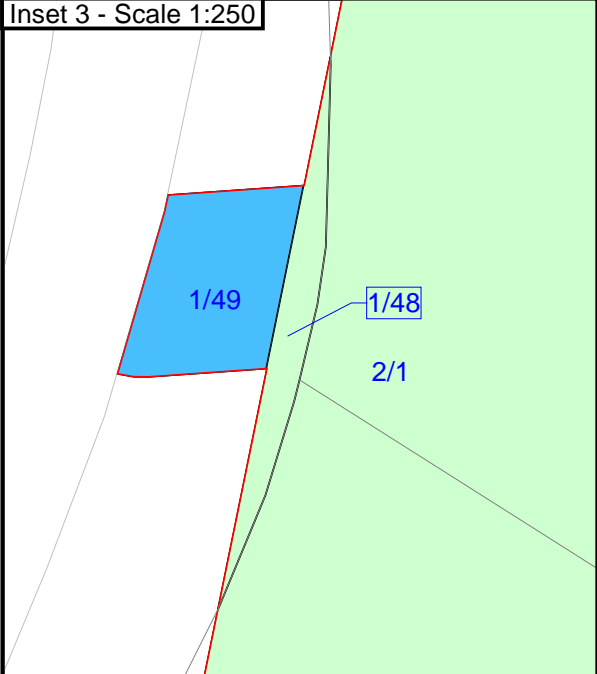
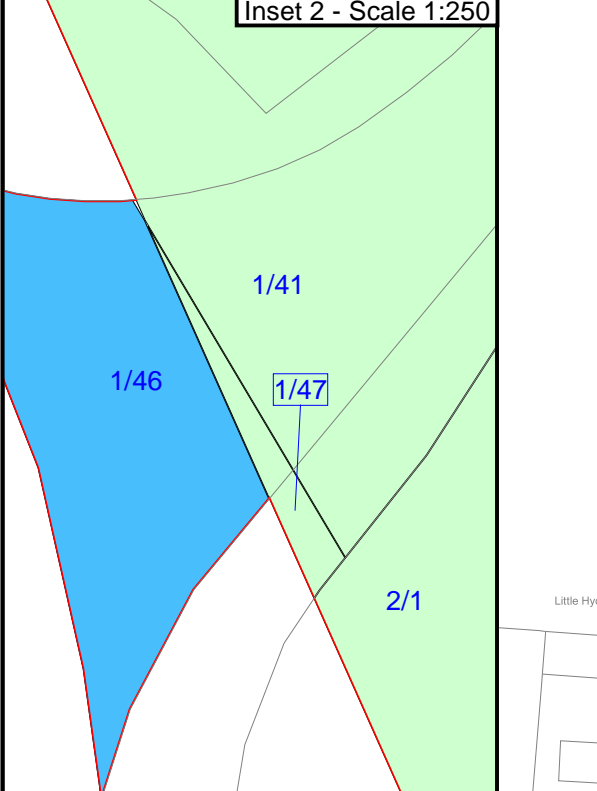
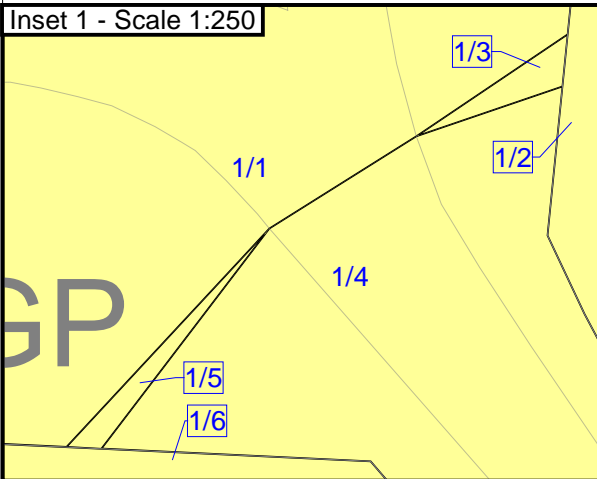

FOR CONTINUATION SEE SHEET 2



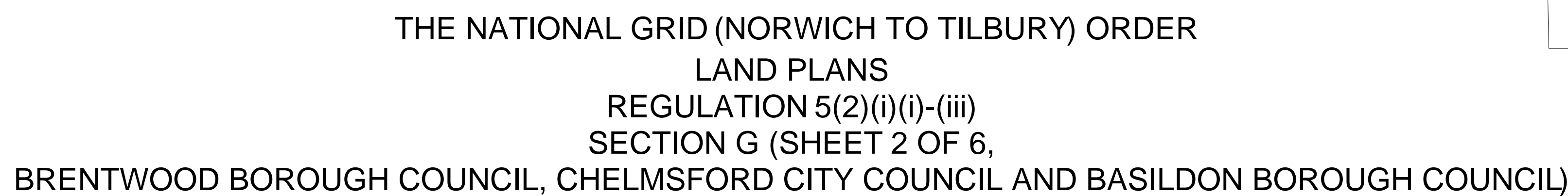

## Legend

- Local authority boundary
- Section boundary & local authority boundary
- .... Section boundary
- Sheet index outlines
- Order Limits
- Class 1 - Compulsory acquisition of land
- Class 2 - Compulsory acquisition of rights - Overhead line
- Class 3 - Compulsory acquisition of rights - Underground cable system
- Class 4 - Compulsory acquisition of rights - Overhead line and underground cable system
- Class 5 - Compulsory acquisition of rights - Access
- Class 6 - Compulsory acquisition of rights - Drainage
- Class 7 - Temporary use
- Class 8 - Land not subject to powers of acquisition nor temporary use

### Notes

1. For additional detail on the plan suites, please refer to the Guide to Plans (document reference 2.0), located in the Volume 2 of the DCO application.
2. This drawing is scaled at paper size A0, therefore any prints taken at smaller sizes will affect accuracy of the measurement units and should not be scaled against.

Coordinate System: British National Grid  
Sheet X Centroid Coordinate : 586032      Sheet Y Centroid Coordinate : 197417



BACKGROUND MAPPING INFORMATION HAS BEEN REPRODUCED FROM THE ORDNANCE SURVEY BY PERMISSION OF ORDNANCE SURVEY OF THE CONTROLLER OF HIS MAJESTY'S STATIONERY OFFICE. © CROWN COPYRIGHT AND DATABASE RIGHTS (2025) LICENCE QS100024241 AND AC0000807948.

B	OCT-2025	October 2025 Update	CBE	AMI	CLJ	
A	AUG-2025	For DCO submission	CBE	AMI	CLJ	
Issue	Date	Remarks	Drawn	Checked	Approved	

Title: \_\_\_\_\_

THE NATIONAL GRID  
(NORWICH TO TILBURY) ORDER  
LAND PLANS  
REGULATION 5(2)(i)-(iii)  
SECTION G (SHEET 2 OF 6  
BRENTWOOD BOROUGH COUNCIL,  
CHELMSFORD CITY COUNCIL  
AND BASILDON BOROUGH COUNCIL)

**nationalgrid**

PINS Application Number

EN020027

National Grid Drawing Reference

<u>Scale</u>	<u>Sheet Size</u>	<u>Sheet</u>	<u>Issue</u>
1:2,500	A0	SHEET 2 of 6	B

[illegible]

FOR CONTINUATION  
SEE SHEET 3



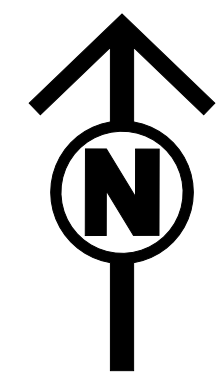

THE NATIONAL GRID (NORWICH TO TILBURY) ORDER  
LAND PLANS  
REGULATION 5(2)(i)-(iii)  
SECTION G (SHEET 3 OF 6,  
BRENTWOOD BOROUGH COUNCIL AND BASILDON BOROUGH COUNCIL)

Application Document 2.2

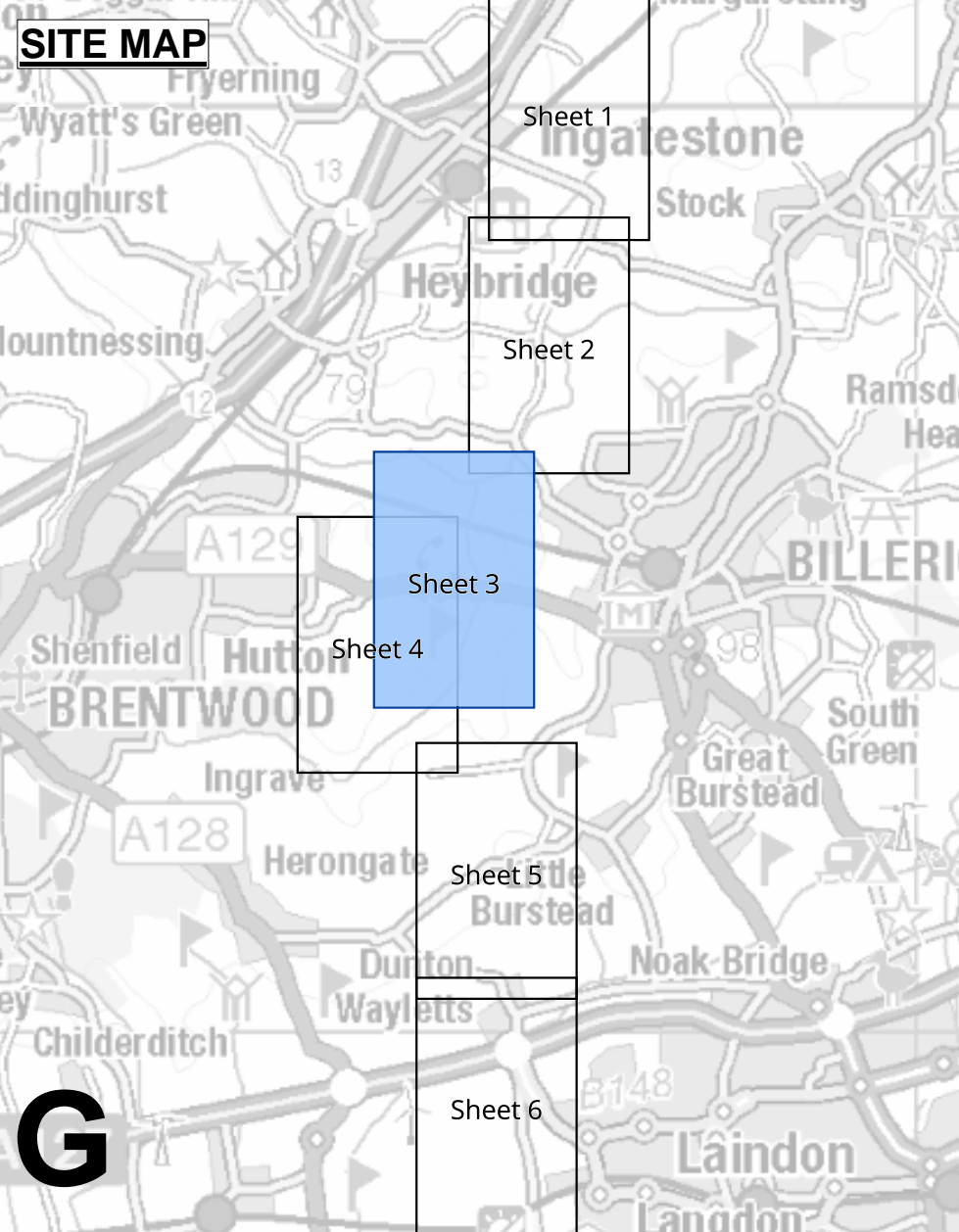

- Legend**
- Local authority boundary
  - Section boundary & local authority boundary
  - Section boundary
  - Sheet index cutlines
  - Order Limits
  - Class 1 - Compulsory acquisition of land
  - Class 2 - Compulsory acquisition of rights - Overhead line
  - Class 3 - Compulsory acquisition of rights - Underground cable system
  - Class 4 - Compulsory acquisition of rights - Overhead line and underground cable system
  - Class 5 - Compulsory acquisition of rights - Access
  - Class 6 - Compulsory acquisition of rights - Drainage
  - Class 7 - Temporary use
  - Class 8 - Land not subject to powers of acquisition nor temporary use

FOR CONTINUATION SEE SHEET 4

FOR CONTINUATION SEE SHEET 2

- Notes**
- For additional detail on the plan suites, please refer to the Guide to Plans (document reference 2.0), located in the Volume 2 of the DCO application.
  - This drawing is scaled at paper size A0, therefore any prints taken at smaller sizes will affect accuracy of the measurement units and should not be scaled against.

Coordinate System: British National Grid  
Sheet X Centroid Coordinate : 565005 Sheet Y Centroid Coordinate : 194885

BACKGROUND MAPPING INFORMATION HAS BEEN REPRODUCED FROM THE ORDNANCE SURVEY BY PERMISSION OF ORDNANCE SURVEY OF THE CONTROLLER OF HIS MAJESTY'S STATIONERY OFFICE. © CROWN COPYRIGHT AND DATABASE RIGHTS (2025) LICENCE OS100024241 AND AC000807946.

Issue	Date	Remarks	Drawn	Checked	Approved
B	OCT-2025	October 2025 Update	CBE	AMI	CLJ
A	AUG-2025	For DCO submission	CBE	AMI	CLJ

**nationalgrid**

PINS Application Number  
EN020027

National Grid Drawing Reference  
AENC-TQST-LAN-DWG-0002

Scale	Sheet Size	Sheet	Issue
1:2,500	A0	SHEET 3 of 6	B



THE NATIONAL GRID (NORWICH TO TILBURY) ORDER  
LAND PLANS  
REGULATION 5(2)(i)-(iii)  
SECTION G (SHEET 4 OF 6,  
BRENTWOOD BOROUGH COUNCIL AND BASILDON BOROUGH COUNCIL)

Application Document 2.2

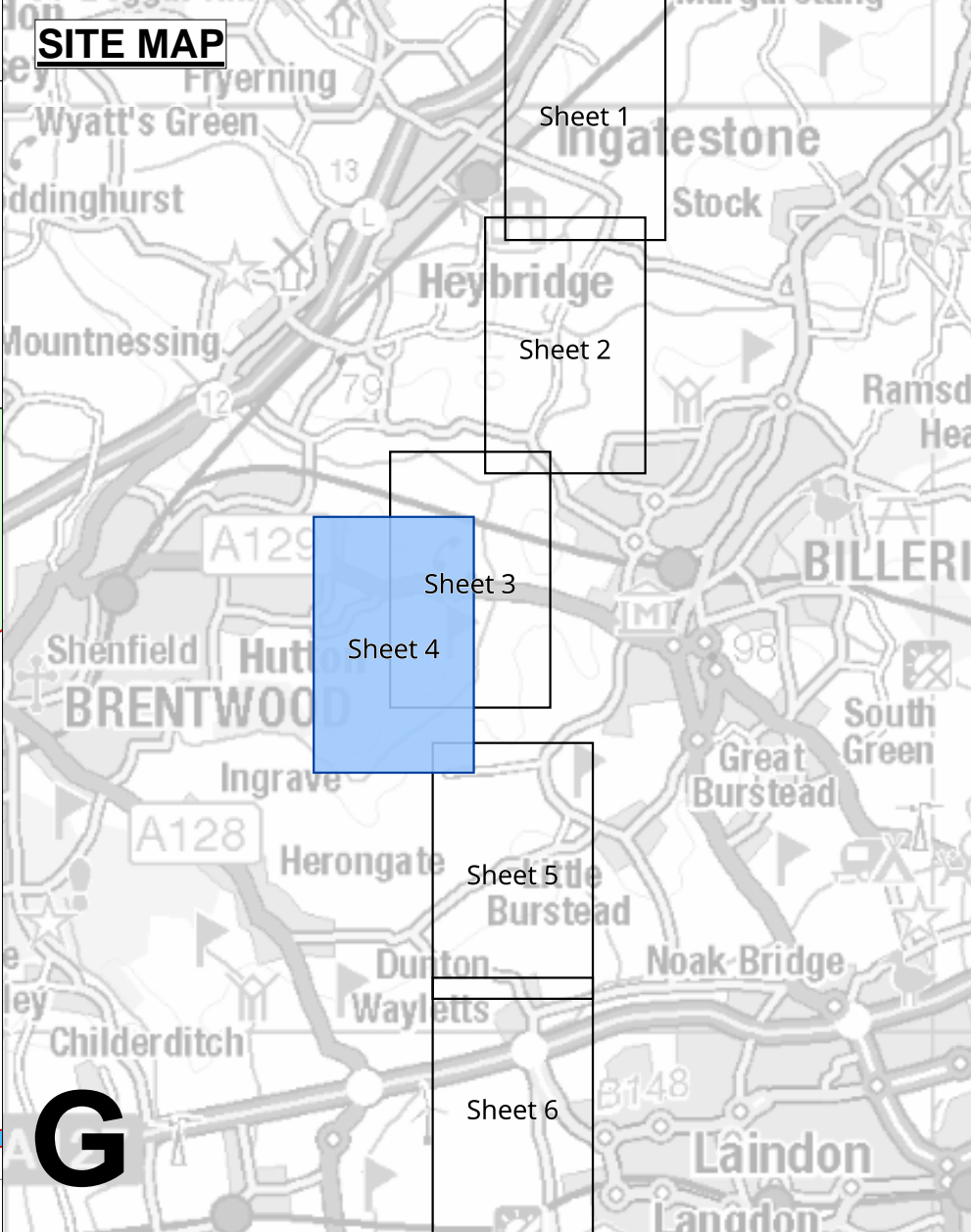
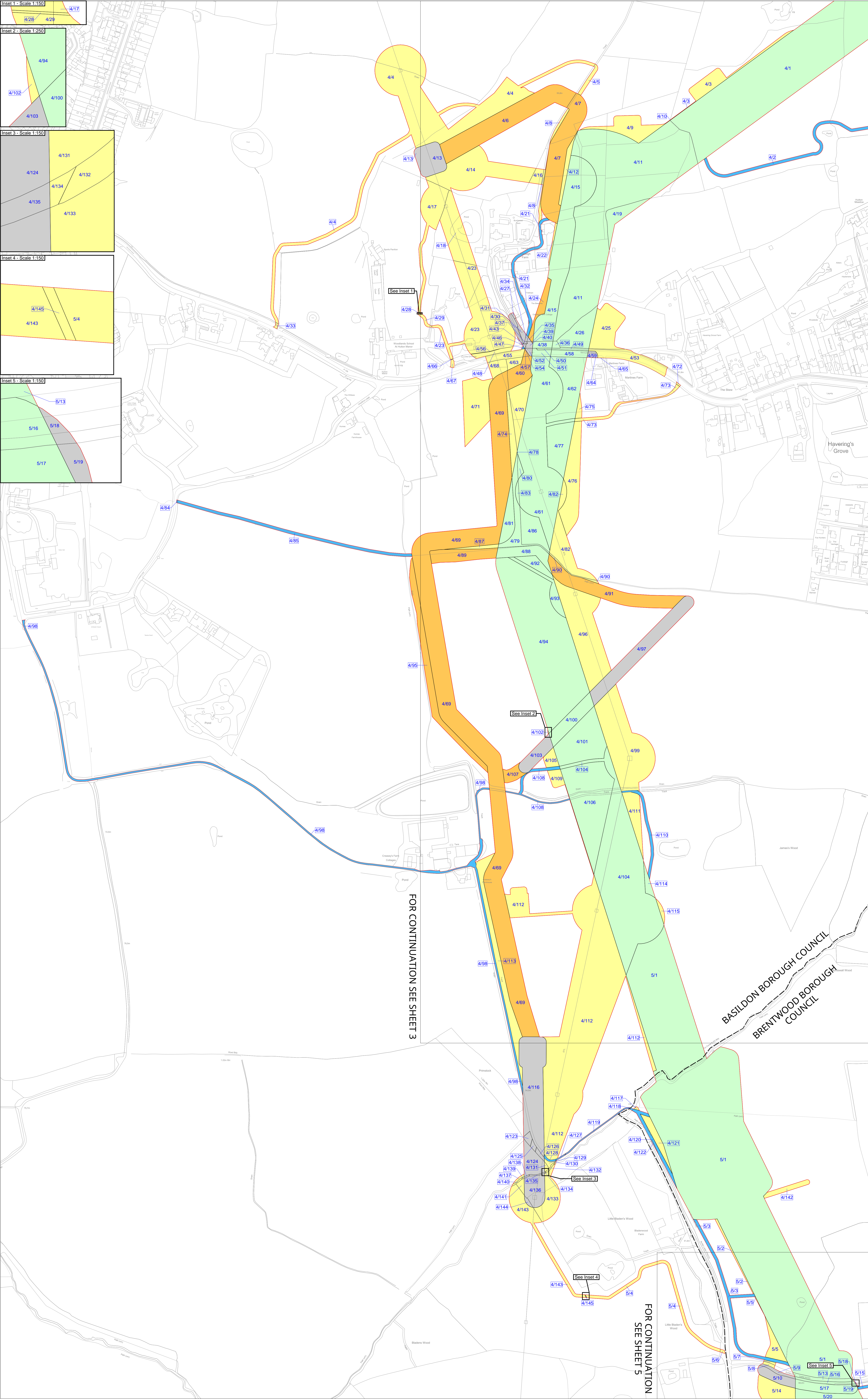
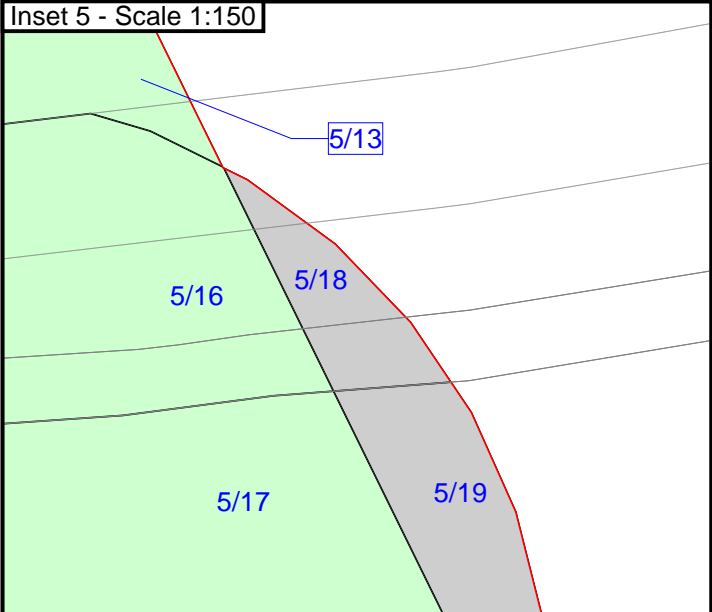
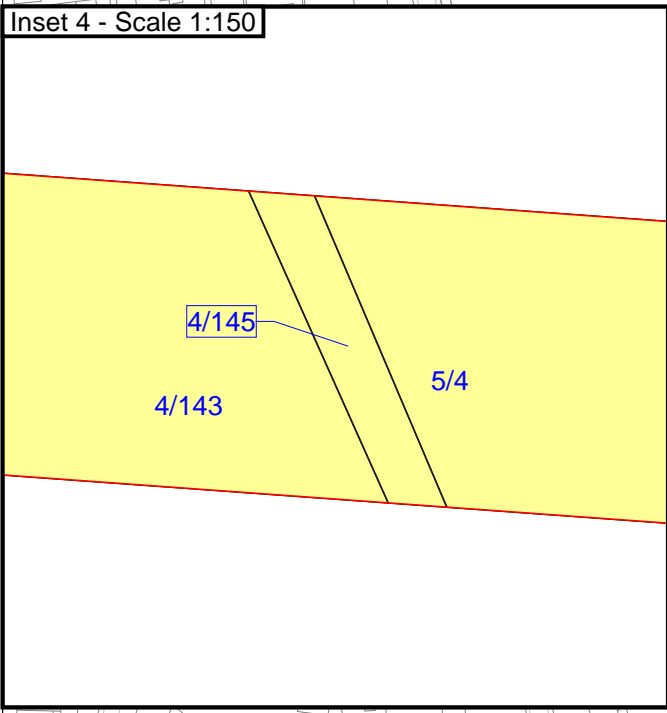
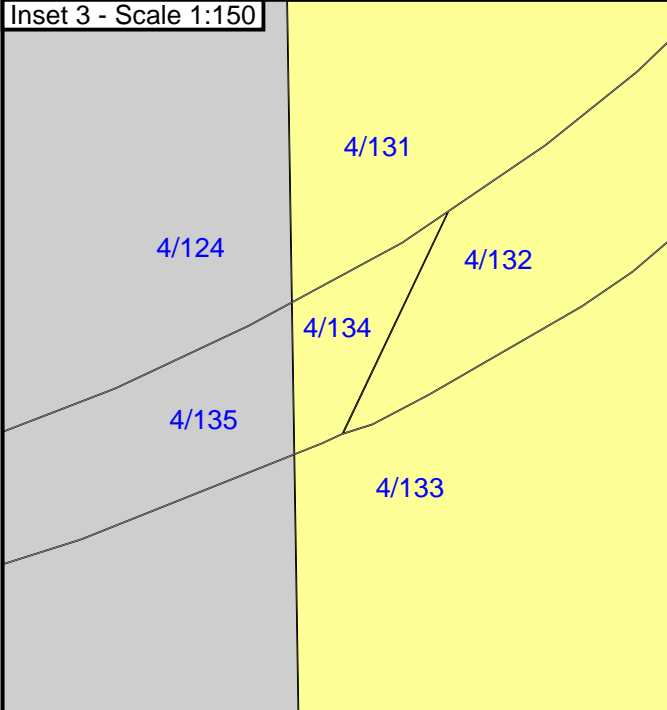
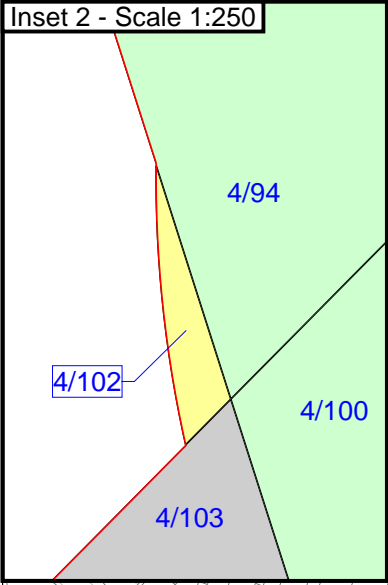
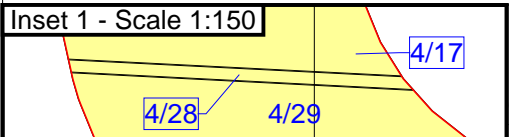
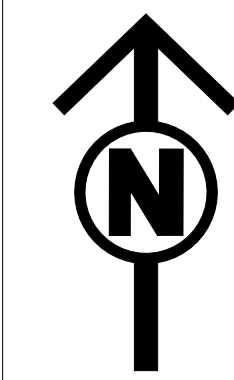

- Legend**
- Local authority boundary
  - Section boundary & local authority boundary
  - Section boundary
  - Sheet index cutlines
  - Order Limits
  - Class 1 - Compulsory acquisition of land
  - Class 2 - Compulsory acquisition of rights - Overhead line
  - Class 3 - Compulsory acquisition of rights - Underground cable system
  - Class 4 - Compulsory acquisition of rights - Overhead line and underground cable system
  - Class 5 - Compulsory acquisition of rights - Access
  - Class 6 - Compulsory acquisition of rights - Drainage
  - Class 7 - Temporary use
  - Class 8 - Land not subject to powers of acquisition nor temporary use

**Notes**

1. For additional detail on the plan suites, please refer to the Guide to Plans (document reference 2.0), located in the Volume 2 of the DCO application.

2. This drawing is scaled at paper size A0, therefore any prints taken at smaller sizes will affect accuracy of the measurement units and should not be scaled against.

Coordinate System: British National Grid  
Sheet X Centroid Coordinate : 564179 Sheet Y Centroid Coordinate : 194182



BACKGROUND MAPPING INFORMATION HAS BEEN REPRODUCED FROM THE ORDNANCE SURVEY BY PERMISSION OF ORDNANCE SURVEY OF THE CONTROLLER OF HIS MAJESTY'S STATIONERY OFFICE. © CROWN COPYRIGHT AND DATABASE RIGHTS (2025) LICENCE OS100024241 AND AC000807946.

Issue	Date	Remarks	Drawn	Checked	Approved
B	OCT-2025	October 2025 Update	BBU	AMI	CLJ
A	AUG-2025	For DCO submission	BBU	AMI	CLJ

**Title:**

THE NATIONAL GRID  
(NORWICH TO TILBURY) ORDER  
LAND PLANS  
REGULATION 5(2)(i)-(iii)  
SECTION G (SHEET 4 OF 6,  
BRENTWOOD BOROUGH COUNCIL  
AND BASILDON BOROUGH COUNCIL)

nationalgrid			
PINS Application Number			
EN020027			
National Grid Drawing Reference			
AENC-TQST-LAN-DWG-0002			
Scale	Sheet Size	Sheet	Issue
1:2,500	A0	SHEET 4 of 6	B



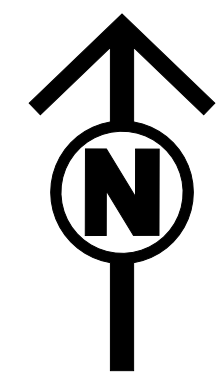

THE NATIONAL GRID (NORWICH TO TILBURY) ORDER  
LAND PLANS  
REGULATION 5(2)(i)(i)-(iii)  
SECTION G (SHEET 5 OF 6,  
BRENTWOOD BOROUGH COUNCIL AND BASILDON BOROUGH COUNCIL)

Application Document 2.2

SITE MAP

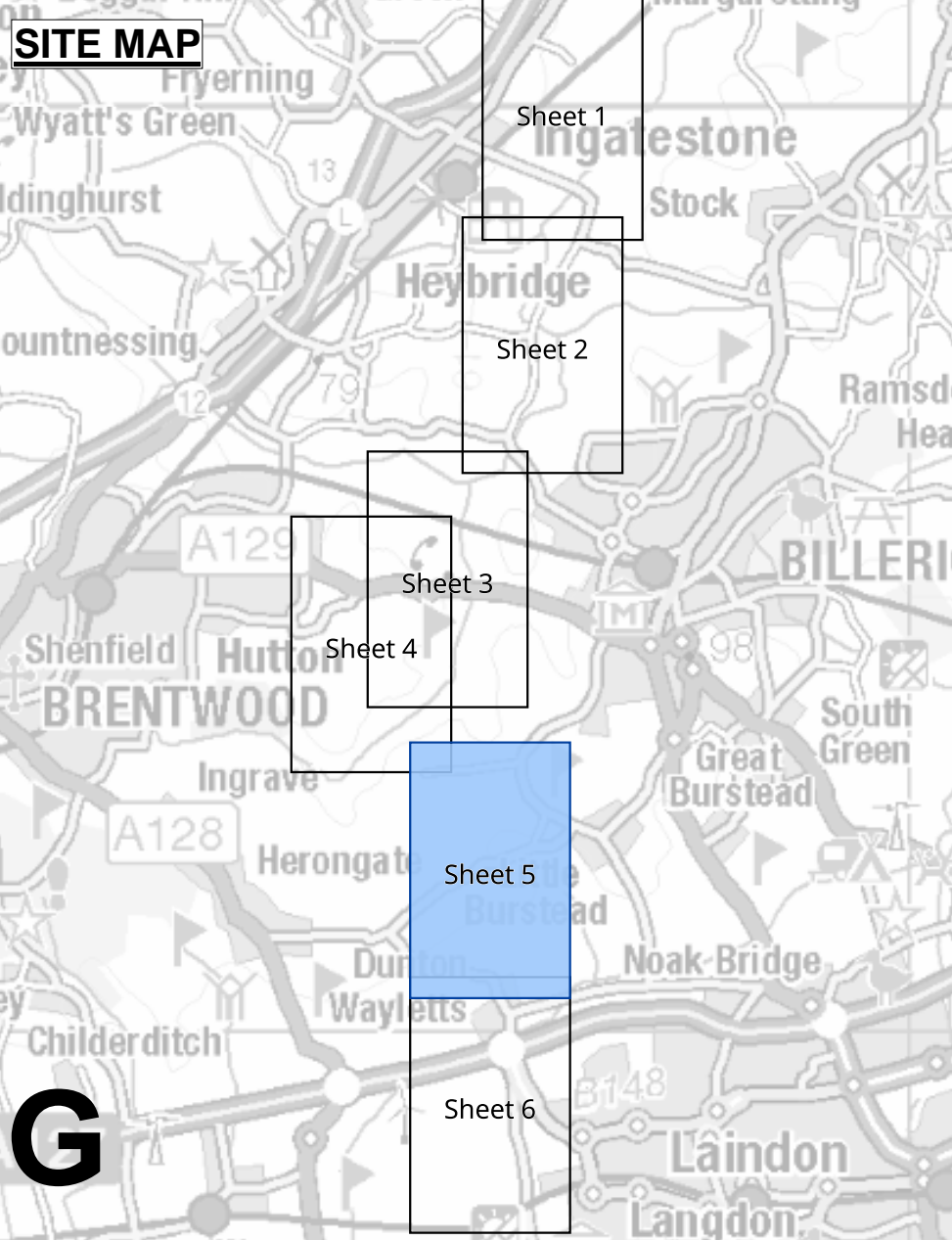

G

Legend

- Local authority boundary
- Section boundary & local authority boundary
- Section boundary
- Sheet index cutlines
- Order Limits
- Class 1 - Compulsory acquisition of land
- Class 2 - Compulsory acquisition of rights - Overhead line
- Class 3 - Compulsory acquisition of rights - Underground cable system
- Class 4 - Compulsory acquisition of rights - Overhead line and underground cable system
- Class 5 - Compulsory acquisition of rights - Access
- Class 6 - Compulsory acquisition of rights - Drainage
- Class 7 - Temporary use
- Class 8 - Land not subject to powers of acquisition nor temporary use

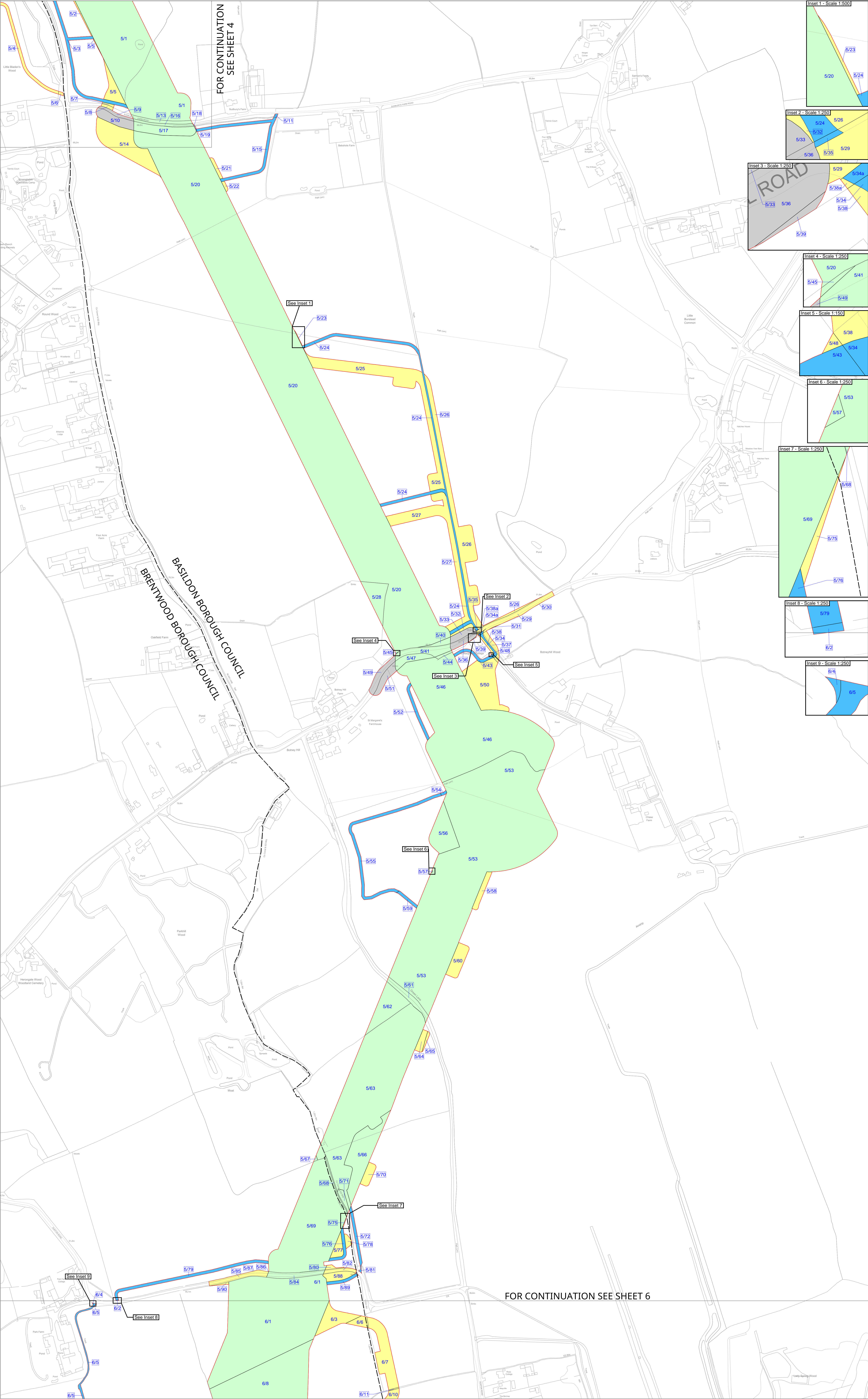

Notes

- For additional detail on the plan suites, please refer to the Guide to Plans (document reference 2.0), located in the Volume 2 of the DCO application.
- This drawing is scaled at paper size A0, therefore any prints taken at smaller sizes will affect accuracy of the measurement units and should not be scaled against.

Coordinate System: British National Grid  
Sheet X Centroid Coordinate : 565465 Sheet Y Centroid Coordinate : 191738

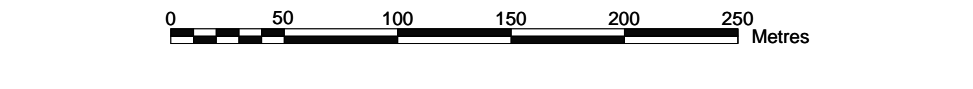

BACKGROUND MAPPING INFORMATION HAS BEEN REPRODUCED FROM THE ORDNANCE SURVEY BY PERMISSION OF ORDNANCE SURVEY OF THE CONTROLLER OF HIS MAJESTY'S STATIONERY OFFICE. © CROWN COPYRIGHT AND DATABASE RIGHTS (2025) LICENCE OS100024241 AND AC000807946.

B	OCT-2025	October 2025 Update	BBU	AMI	CLJ
A	AUG-2025	For DCO submission	BBU	AMI	CLJ

Issue	Date	Remarks	Drawn	Checked	Approved
-------	------	---------	-------	---------	----------

Title:

THE NATIONAL GRID  
(NORWICH TO TILBURY) ORDER  
LAND PLANS  
REGULATION 5(2)(i)(i)-(iii)  
SECTION G (SHEET 5 OF 6,  
BRENTWOOD BOROUGH COUNCIL  
AND BASILDON BOROUGH COUNCIL)

nationalgrid

PINS Application Number  
EN020027

National Grid Drawing Reference  
AENC-TQST-LAN-DWG-0002

Scale	Sheet Size	Sheet	Issue
-------	------------	-------	-------

1:2,500 A0 SHEET 5 of 6 B



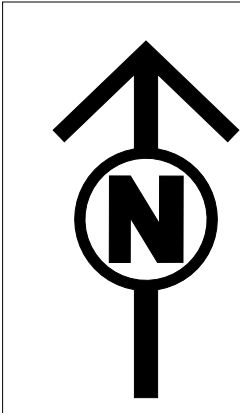

THE NATIONAL GRID (NORWICH TO TILBURY) ORDER  
LAND PLANS  
REGULATION 5(2)(i)-(iii)  
SECTION G (SHEET 6 OF 6,  
BRENTWOOD BOROUGH COUNCIL, BASILDON BOROUGH COUNCIL AND THURROCK COUNCIL)

Application Document 2.2

SITE MAP

G

Legend

- Local authority boundary
- Section boundary & local authority boundary
- Section boundary
- Sheet index cutlines
- Order Limits
- Class 1 - Compulsory acquisition of land
- Class 2 - Compulsory acquisition of rights - Overhead line
- Class 3 - Compulsory acquisition of rights - Underground cable system
- Class 4 - Compulsory acquisition of rights - Overhead line and underground cable system
- Class 5 - Compulsory acquisition of rights - Access
- Class 6 - Compulsory acquisition of rights - Drainage
- Class 7 - Temporary use
- Class 8 - Land not subject to powers of acquisition nor temporary use

Notes

- For additional detail on the plan suites, please refer to the Guide to Plans (document reference 2.0), located in the Volume 2 of the DCO application.
- This drawing is scaled at paper size A0, therefore any prints taken at smaller sizes will affect accuracy of the measurement units and should not be scaled against.

Coordinate System: British National Grid  
Sheet X Centroid Coordinate : 565465 Sheet Y Centroid Coordinate : 189201

BACKGROUND MAPPING INFORMATION HAS BEEN REPRODUCED FROM THE ORDNANCE SURVEY BY PERMISSION OF ORDNANCE SURVEY OF THE CONTROLLER OF HIS MAJESTY'S STATIONERY OFFICE. © CROWN COPYRIGHT AND DATABASE RIGHTS (2025) LICENCE OS100024241 AND AC000807946.

Issue	Date	Remarks	Drawn	Checked	Approved
B	OCT-2025	October 2025 Update	BBU	AMI	CLJ
A	AUG-2025	For DCO submission	BBU	AMI	CLJ

Title:  
THE NATIONAL GRID  
(NORWICH TO TILBURY) ORDER  
LAND PLANS  
REGULATION 5(2)(i)-(iii)  
SECTION G (SHEET 6 OF 6,  
BRENTWOOD BOROUGH COUNCIL,  
BASILDON BOROUGH COUNCIL  
AND THURROCK COUNCIL)

nationalgrid  
PINS Application Number  
EN020027  
National Grid Drawing Reference  
AENC-TOST-LAN-DWG-0002

Scale	Sheet Size	Sheet	Issue
1:2,500	A0	SHEET 6 of 6	B

FOR CONTINUATION SEE SHEET 5

SECTION G  
BRENTWOOD BOROUGH COUNCIL

SECTION H  
THURROCK COUNCIL